



## Classic TBi 241

Water cooled

Robust and flexible water-power cable

Uses same consumables as TBi 240

### Technical data

#### MIG / MAG (GMAW) Semi-automatic welding torch TBi 241

Rating at 100% duty cycle  
(10 min. cycle)

- Mixed gas: 270 A  
- CO<sub>2</sub>: 300 A

Cooling method Water cooling

Wire diameter 0.8 - 1.2 mm

Gas flow 14 l/min

Technical specification according to IEC 60974-7

Weight with 1.5 m cable 1.50 kg

Connection Euro-Central connector  
other connectors are available upon request.

Torch rating will be reduced when using pulsed-arc power sources. Special torch necks and custom lengths of the cable assembly are available upon request.

### Ordering Information

TBi 241 ESW, 50° bent 123P4415\_0\*

\* At the blank, please insert 3, 4 or 5 for a torch length of 3, 4 or 5 m.

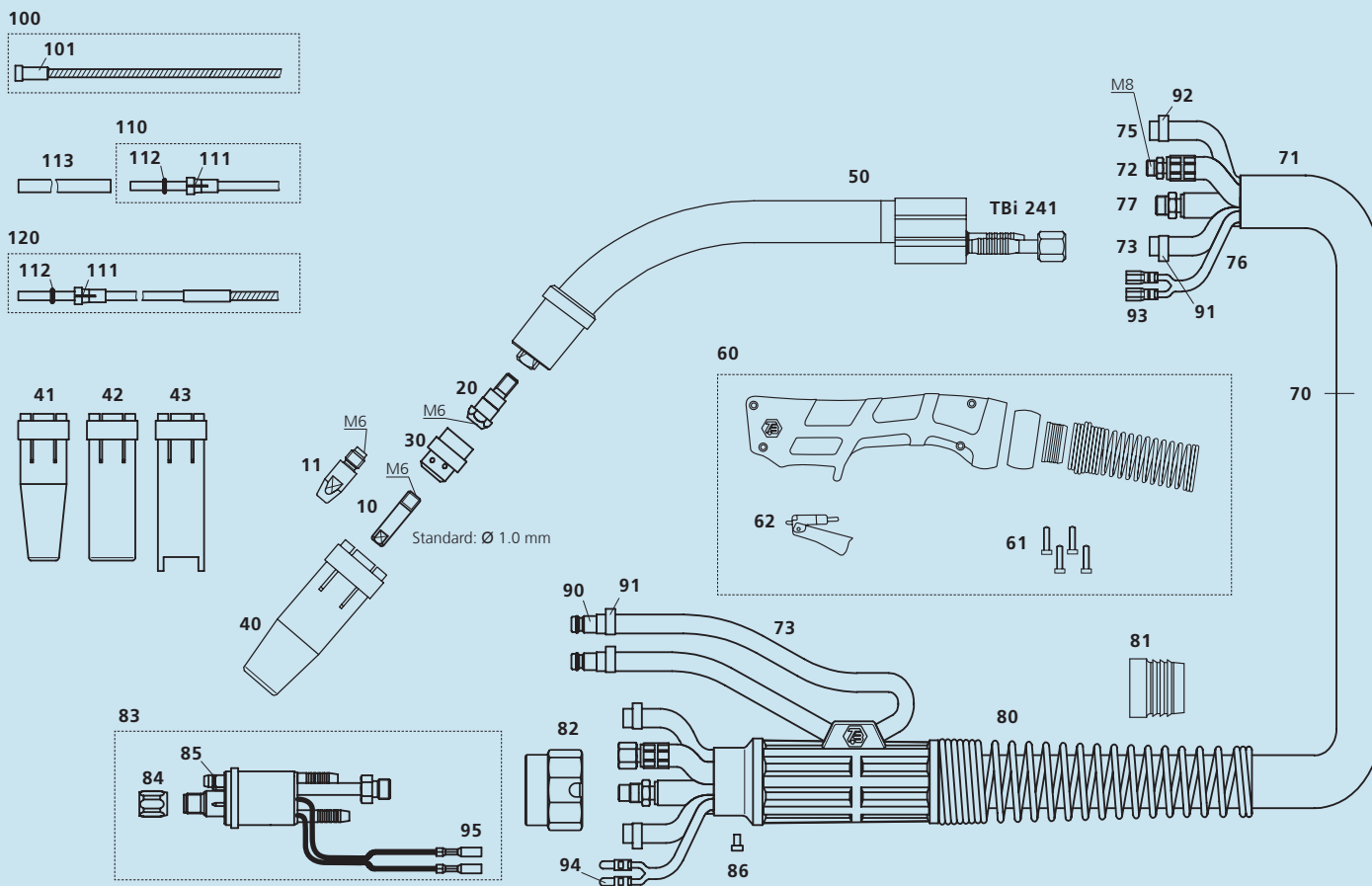

Pos. Description

Part. No.

#### Contact tips

▶ <b>10</b>	<b>Contact tip M6x25, Ecu</b>	<b>340P_1073*</b>
10	Contact tip M6x25, CuCrZr	340P_3073*
10	Contact tip M6x25 Alu, Ecu	341P_1073*
11	Contact tip M6x28, Ecu	340P_1069*
11	Contact tip M6x28, CuCrZr	340P_3069*
11	Contact tip M6x28 Alu, Ecu	341P_1069*

#### Tip holders

▶ <b>20</b>	<b>Tip holder M6 / L=26 mm</b>	<b>342P006012</b>
-------------	--------------------------------	-------------------

#### Gas diffusers

▶ <b>30</b>	<b>Gas diffuser, red</b>	<b>112P002019</b>
30	Gas diffuser, black	112P002024
30	Gas diffuser, ceramic	112P002021

#### Gas nozzles

▶ <b>40</b>	<b>Nozzle conical diam. 12.5 mm</b>	<b>345P012012</b>
40	Nozzle conical diam. 12.5 mm HD	345P012312
41	Nozzle conical diam. 10 mm	345P013012
42	Nozzle cylindrical diam. 17 mm	345P011012
42	Nozzle cylindrical diam. 17 mm HD	345P011312
43	Spot weld nozzle diam. 17 mm	345P015012

#### Spare parts

50	Torch neck TBi 241, 50°	123P001001
60	Handle blue, watercooled, cpl. kit	380P220401
61	Cross recessed screw M 3.5x14	100P008413
62	Trigger, red, 2 poles	385P021016
70	Cable assembly Classic, 2-C	122P4045_0*

Pos. Description

Part. No.

71	Fabric outer cover 25x1.5 mm, cpl.	307P2528_A*
72	Water-power cable Classic, blue, 2-C	316P1621_0*
73	PVC hose, braided, black, 5x1.5 mm	302P020000
75	PVC-Gas hose, black 4.5x1.5 mm	302P010000
76	Control cable x.30 m cpl.	301P2304_0*
77	Wire conduit yellow 'Classic'	356P0401_0*
80	Cable support 3 parts cpl. with spring	701P101071
81	Clamping ring for outer cover	600P102201
82	Adaptor nut	701P001013
83	Central adaptor ESW cpl., 2 poles, moveable pins	701P001049
84	Sleeve nut M10x1	701P002005
85	O-ring 4.0x1.0 mm (gas nipple)	365P100040
86	Slotted screw M4x6	100P008401
90	Quick connector	701P002064
91	Hose clamp Ø 9.5 with ring	373P100095
92	Hose clamp Ø 8.7	371P000087
93	Cable lug, flat	375P000023
94	Insulated connector, male, round	375P000004
95	Insulated connector, female, round	375P000003

#### Wire guides

▶ <b>100</b>	<b>Liner w/o insulation (x.40 m) for wire 1.0-1.2</b>	<b>322P2045_4*</b>
100	Liner w/ insulation blue (x.40 m) for wire 0.8-1.0	324P1545_4*
101	Collet for liners diam. 4.5 mm	330P025045
110	PTFE-liner blue (x.50 m) for wire 0.8-1.0	326P1540_5*
110	PTFE-liner red (x.50 m) for wire 1.0-1.2	326P2040_5*
111	Collet for liners 2.0x4.0 mm	331P020040
112	O-ring 3.50x1.50 mm (for liner)	365P150035
113	Support tube 5x4.4 mm, L=150 mm	329P544150
120	PA-Alu wire guide (x.50 m) for wire 1.0-1.2	328P2040_A*

▶ = Standard parts

\* At the blank, please insert suitable information for torch length or wire diameter, e.g. 08 for 0.8 mm or 3 for 3 mm.

© 2012 TBI Industries GmbH. All rights reserved. Subject to change without notice. Warranty only when using original TBI consumables and spare parts. Excerpts and reprints not permitted. Nr. DOKP111182, 12/2012.

TBI Industries GmbH  
Ruhberg 14  
D-35463 Fernwald-Steinbach  
P.O. Box 67  
D-35461 Fernwald-Steinbach

Tel. + 49 6404 9171-0  
Fax. + 49 6404 9171-40  
Internet: [www.tbi-industries.com](http://www.tbi-industries.com)  
E-mail: [info@tbi-industries.com](mailto:info@tbi-industries.com)